

Arctica Signature Series

Presentation is Everything™

49" High Volume

- RH3-38-49 38.25"L x 34.19"D x 49.38"H
 - RH3-48-49 47.81"L x 34.19"D x 49.38"H
 - RH3-57-49 57.38"L x 34.19"D x 49.38"H
 - RH3-76-49 76.50"L x 34.19"D x 49.38"H
 - RH3-96-49 95.63"L x 34.19"D x 49.38"H
 - RH3-115-49 114.75"L x 34.19"D x 49.38"H
- Self-Contained Remote Dry

Item #:	_____
Project:	_____
Date:	_____

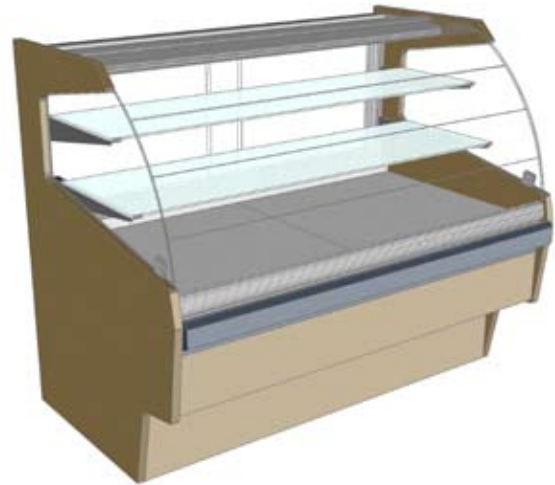

*Arctica recommended for:
Bakery and Deli.*

49" High Volume	Standard Specifications:	Options:
Construction	<input type="checkbox"/> Welded aluminum frame construction <input type="checkbox"/> Levelers <input type="checkbox"/> Brushed steel interior <input type="checkbox"/> Tilt-out front glass	
Glass	<input type="checkbox"/> Low profile glass (DL)	<input type="checkbox"/> Flat glass (FG)
Shelf Supports	<input type="checkbox"/> Epoxy powder painted (black)	<input type="checkbox"/> Epoxy powder painted (white) <input type="checkbox"/> Epoxy powder painted (colour): _____
Shelves	<input type="checkbox"/> Glass shelves	
Aluminum Trim	<input type="checkbox"/> Satin finish	<input type="checkbox"/> Chrome anodized <input type="checkbox"/> Brass anodized <input type="checkbox"/> Epoxy powder painted (colour): _____
End/Divider Glass	<input type="checkbox"/> 1/4" tempered glass	<input type="checkbox"/> 1/4" tempered glass mirrored
Sliding Doors	<input type="checkbox"/> Pike glass	<input type="checkbox"/> Pike glass mirrored
End Panels/Decorboard/ Kickboard	<input type="checkbox"/> Choice of 8 standard colours: _____	<input type="checkbox"/> Hardwood veneer <input type="checkbox"/> Stainless steel
Fold-Down Work Shelf	<input type="checkbox"/> Wilsonart frosty white	<input type="checkbox"/> Saniboard <input type="checkbox"/> Surell (similar to Corian) <input type="checkbox"/> Stainless steel
Equipment	<input type="checkbox"/> Defogging system <input type="checkbox"/> Adjustable shelves <input type="checkbox"/> Removable end panels	<input type="checkbox"/> Humidification system <input type="checkbox"/> Self-service doors

1.800.839.5536

www.arctica.ca



ARCTICA
Signature Series
CUSTOM DISPLAY SYSTEMS

Arctica Signature Series

Presentation is Everything™

49" High Volume

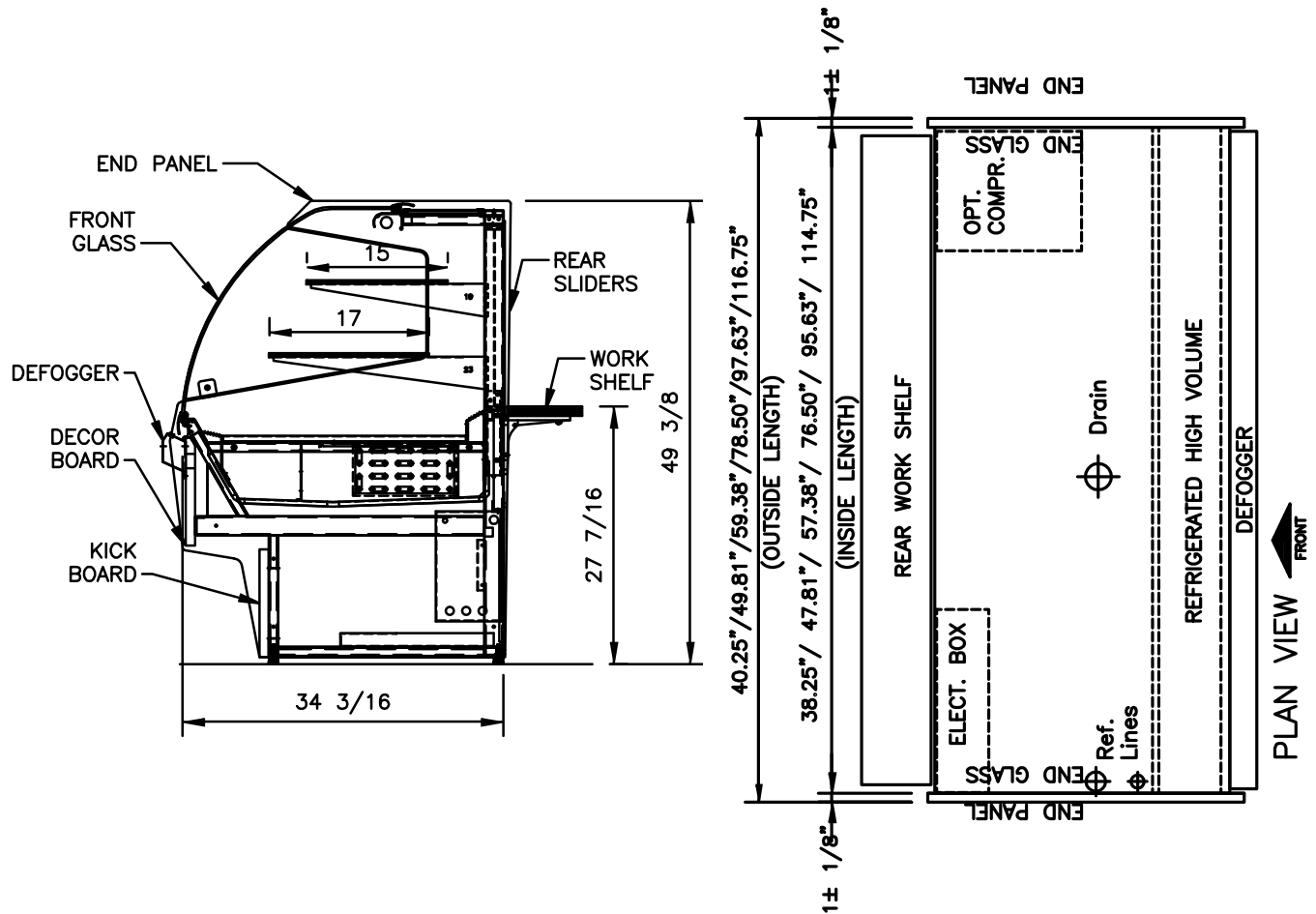

Model	Length (inches)	Length (millimeters)	Voltage	Amps (Remote)	Amps (Self-Contained)	Amps (Dry)
RH3-38-49	38.25"	972mm	115V / 1 / 60	2.1	11.5	
RH3-48-49	47.81"	1,214mm	115V / 1 / 60	2.3	13.0	
RH3-57-49	57.38"	1,457mm	115V / 1 / 60	2.7	13.4	1.0 for all models; a single 115V hook-up required for all dry models.
RH3-76-49	76.50"	1,943mm	115V / 1 / 60 230V / 1 / 60	3.6	3.6 8.7	
RH3-96-49	95.63"	2,429mm	115V / 1 / 60 230V / 1 / 60	4.3	11.8* 8.7	
RH3-115-49	114.75"	2,915mm	115V / 1 / 60 230V / 1 / 60	4.7	12.2* 8.7	

*Call factory: (1) if you have drain accessibility, and/or (2) if you're looking for savings; depending on your geographic location, you could save 900 to 1500 Watts of electrical energy.

SPECS: aluminum support frame; leveling legs; brushed stainless steel interior; epoxy painted upper structure; anodized aluminum trim; .25 tempered shelf; end and front curved glass; tilt-out front glass standard.; lights with spectrum sleeves all shelves; laminated plywood finish; self-contained (R134a) with hot gas evaporator or remote; refrigerated cases are fitted with a defogging system that will keep the front glass clear of moisture in a controlled environment not exceeding 75°F and 55% relative humidity. ETL sanitation listed to NSF Standard 2, 4 and 7.

