

Arctica Signature Series

Presentation is Everything™

52" High Volume

- RH3-38-52 38.25"L x 34.19"D x 52.06"H
 - RH3-48-52 47.81"L x 34.19"D x 52.06"H
 - RH3-57-52 57.38"L x 34.19"D x 52.06"H
 - RH3-76-52 76.50"L x 34.19"D x 52.06"H
 - RH3-96-52 95.63"L x 34.19"D x 52.06"H
 - RH3-115-52 114.75"L x 34.19"D x 52.06"H
- Self-Contained Remote Dry

| | |
|----------|-------|
| Item #: | _____ |
| Project: | _____ |
| Date: | _____ |

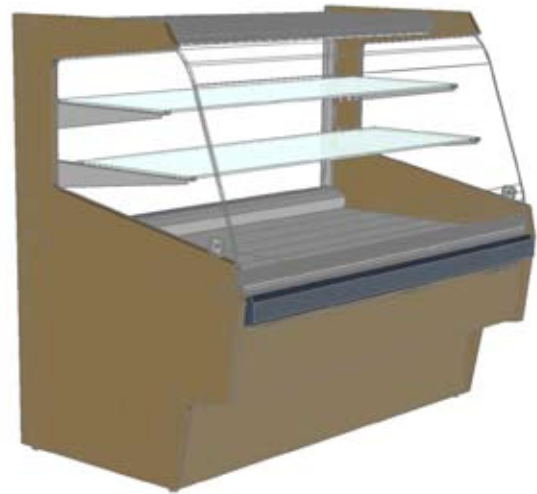

*Arctica recommended for:
Bakery and Deli.*

| 52" High Volume | Standard Specifications: | Options: |
|---|--|---|
| Construction | <input type="checkbox"/> Welded aluminum frame construction <input type="checkbox"/> Levelers <input type="checkbox"/> Brushed steel interior <input type="checkbox"/> Tilt-out front glass | |
| Glass | <input type="checkbox"/> Low profile glass (DL) | <input type="checkbox"/> Flat glass (FG) |
| Shelf Supports | <input type="checkbox"/> Epoxy powder painted (black) | <input type="checkbox"/> Epoxy powder painted (white) <input type="checkbox"/> Epoxy powder painted (colour): _____ |
| Shelves | <input type="checkbox"/> Glass shelves | |
| Aluminum Trim | <input type="checkbox"/> Satin finish | <input type="checkbox"/> Chrome anodized <input type="checkbox"/> Brass anodized <input type="checkbox"/> Epoxy powder painted (colour): _____ |
| End/Divider Glass | <input type="checkbox"/> 1/4" tempered glass | <input type="checkbox"/> 1/4" tempered glass mirrored |
| Sliding Doors | <input type="checkbox"/> Pike glass | <input type="checkbox"/> Pike glass mirrored |
| End Panels/Decorboard/ Kickboard | <input type="checkbox"/> Choice of 8 standard colours: _____ | <input type="checkbox"/> Hardwood veneer <input type="checkbox"/> Stainless steel |
| Fold-Down Work Shelf | <input type="checkbox"/> Wilsonart frosty white | <input type="checkbox"/> Saniboard <input type="checkbox"/> Surell (similar to Corian) <input type="checkbox"/> Stainless steel |
| Equipment | <input type="checkbox"/> Defogging system <input type="checkbox"/> Adjustable shelves <input type="checkbox"/> Removable end panels | <input type="checkbox"/> Humidification system <input type="checkbox"/> Self-service doors |

1.800.839.5536

www.arctica.ca



ARCTICA
Signature Series
CUSTOM DISPLAY SYSTEMS

Arctica Signature Series

Presentation is Everything™

52" High Volume

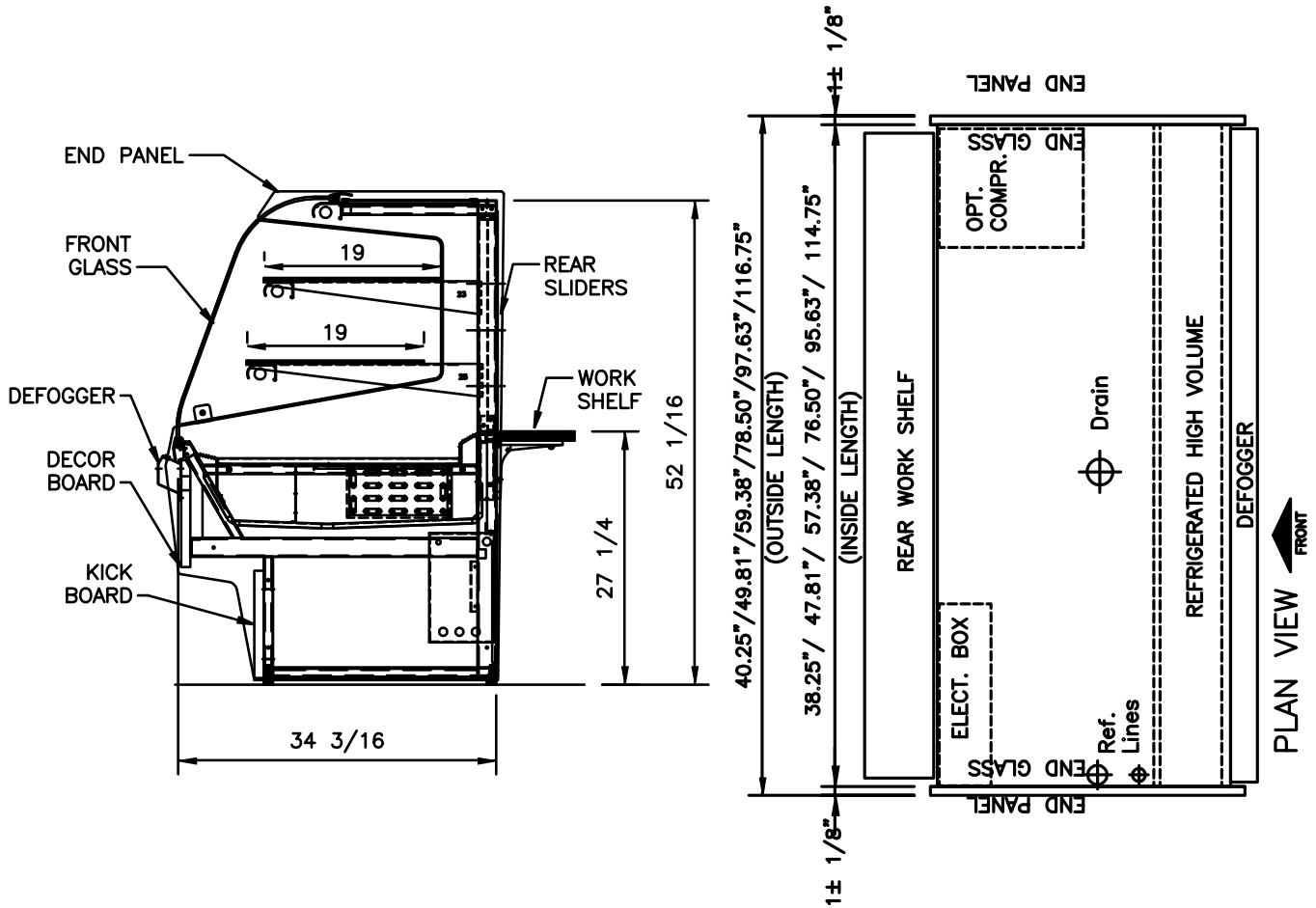

| Model | Length (inches) | Length (millimeters) | Voltage | Amps (Remote) | Amps (Self-Contained) | Amps (Dry) |
|------------|-----------------|----------------------|--------------------------------|---------------|-----------------------|--|
| RH3-38-52 | 38.25" | 972mm | 115V / 1 / 60 | 2.1 | 11.5 | |
| RH3-48-52 | 47.81" | 1,214mm | 115V / 1 / 60 | 2.3 | 13.0 | |
| RH3-57-52 | 57.38" | 1,457mm | 115V / 1 / 60 | 2.7 | 13.4 | 1.0 for all models; a single 115V hook-up required for all dry models. |
| RH3-76-52 | 76.50" | 1,943mm | 115V / 1 / 60 230V / 1 / 60 | 3.6 | 3.6 8.7 | |
| RH3-96-52 | 95.63" | 2,429mm | 115V / 1 / 60 230V / 1 / 60 | 4.3 | 11.8 8.7 | |
| RH3-115-52 | 114.75" | 2,915mm | 115V / 1 / 60 | 4.7 | 12.2 | |
| | | | 230V / 1 / 60 | | 8.7 | |

SPECS: aluminum support frame; leveling legs; brushed stainless steel interior; epoxy painted upper structure; anodized aluminum trim; .25 tempered shelf; end and front curved glass; tilt-out front glass standard.; lights with spectrum sleeves all shelves; laminated plywood finish; self-contained (R134a) with hot gas evaporator or remote; refrigerated cases are fitted with a defogging system that will keep the front glass clear of moisture in a controlled environment not exceeding 75°F and 55% relative humidity. ETL sanitation listed to NSF Standard 2, 4 and 7.

