

# Arctica Signature Series

Presentation is Everything™

## 52" Standard

- RST-38-52      38.25"L x 34.19"D x 52.06"H
- RST-48-52      47.81"L x 34.19"D x 52.06"H
- RST-57-52      57.38"L x 34.19"D x 52.06"H
- RST-76-52      76.50"L x 34.19"D x 52.06"H
- RST-96-52      95.63"L x 34.19"D x 52.06"H
- RST-115-52     114.75"L x 34.19"D x 52.06"H
- Self-Contained     Remote       Dry

Item #:	_____
Project:	_____
Date:	_____

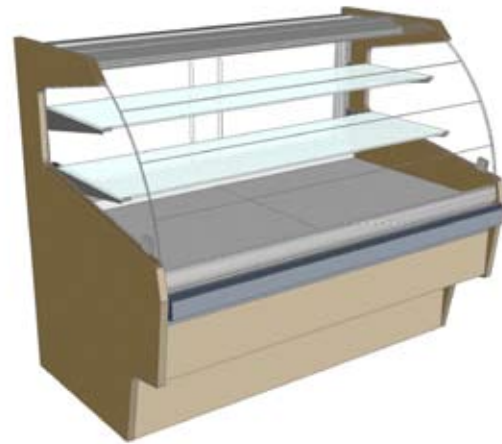

*Arctica recommended for:  
Bakery and Deli.*

52" Standard	Standard Specifications:	Options:
<b>Construction</b>	<input type="checkbox"/> Welded aluminum frame construction <input type="checkbox"/> Levelers <input type="checkbox"/> Brushed steel interior <input type="checkbox"/> Tilt-out front glass	<input type="checkbox"/> Lift-up front glass
<b>Glass</b>	<input type="checkbox"/> Low profile glass (DL)	<input type="checkbox"/> Flat glass (FG)
<b>Shelf Supports</b>	<input type="checkbox"/> Epoxy powder painted (black)	<input type="checkbox"/> Epoxy powder painted (white) <input type="checkbox"/> Epoxy powder painted (colour): _____
<b>Shelves</b>	<input type="checkbox"/> Glass shelves	
<b>Aluminum Trim</b>	<input type="checkbox"/> Satin finish	<input type="checkbox"/> Chrome anodized <input type="checkbox"/> Brass anodized <input type="checkbox"/> Epoxy powder painted (colour): _____
<b>End/Divider Glass</b>	<input type="checkbox"/> 1/4" tempered glass	<input type="checkbox"/> 1/4" tempered glass mirrored
<b>Sliding Doors</b>	<input type="checkbox"/> Pike glass	<input type="checkbox"/> Pike glass mirrored
<b>End Panels/Decorboard/ Kickboard</b>	<input type="checkbox"/> Choice of 8 standard colours: _____	<input type="checkbox"/> Hardwood veneer <input type="checkbox"/> Stainless steel
<b>Fold-Down Work Shelf</b>	<input type="checkbox"/> Wilsonart frosty white	<input type="checkbox"/> Saniboard <input type="checkbox"/> Surell (similar to Corian) <input type="checkbox"/> Stainless steel
<b>Equipment</b>	<input type="checkbox"/> Defogging system <input type="checkbox"/> Adjustable shelves <input type="checkbox"/> Removable end panels	<input type="checkbox"/> Humidification system <input type="checkbox"/> Self-service doors

1.800.839.5536

www.arctica.ca



ARCTICA  
Signature Series  
CUSTOM DISPLAY SYSTEMS

# Arctica Signature Series

Presentation is Everything™

52" Standard

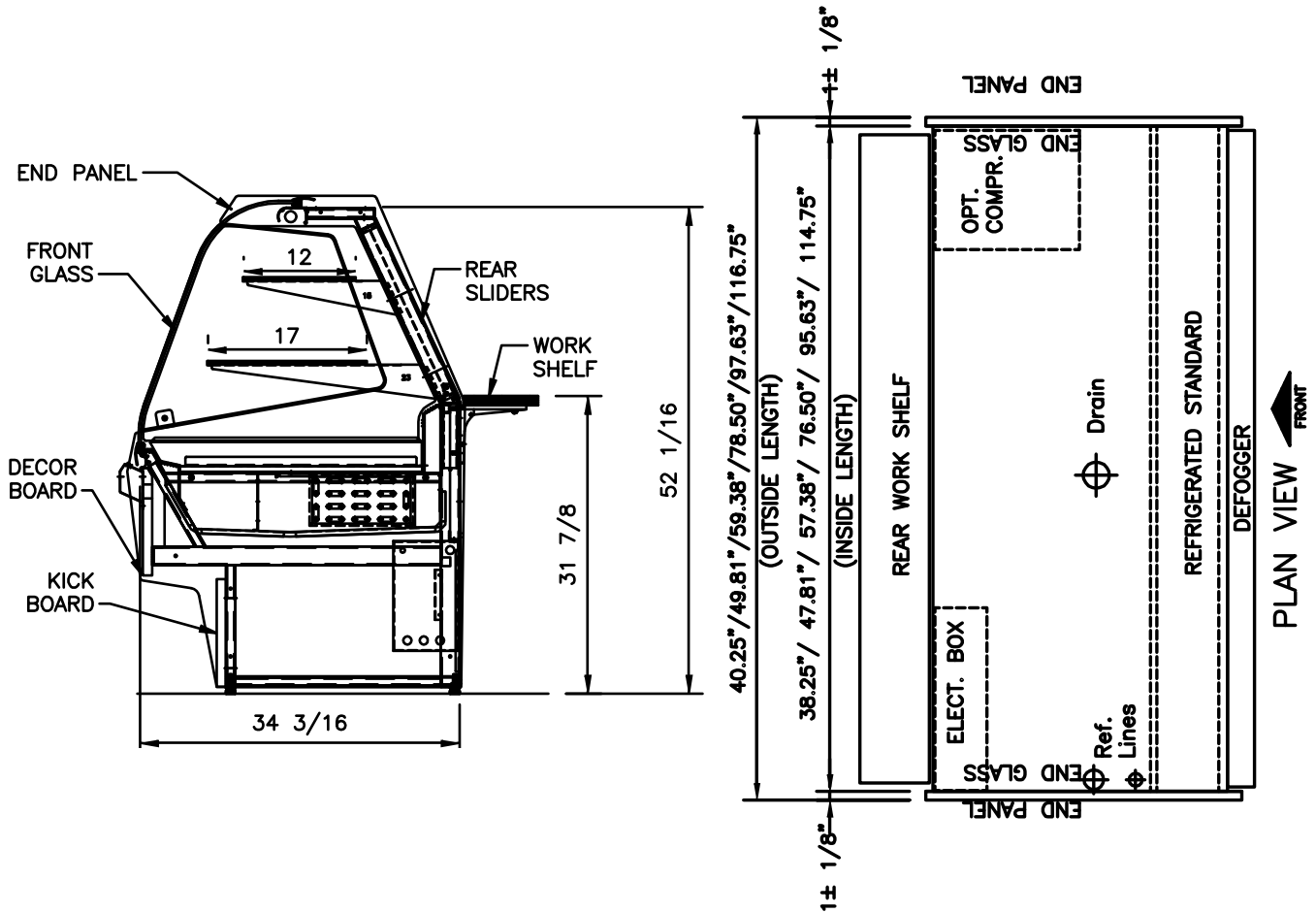

Model	Length (inches)	Length (millimeters)	Voltage	Amps (Remote)	Amps (Self-Contained)
RST-38-52	38.25"	972mm	115V / 1 / 60	2.1	11.5
RST-48-52	47.81"	1,214mm	115V / 1 / 60	2.3	13.0
RST-57-52	57.38"	1,457mm	115V / 1 / 60	2.7	13.4
RST-76-52	76.50"	1,943mm	115V / 1 / 60 230V / 1 / 60	3.6	3.6 8.7
RST-96-52	95.63"	2,429mm	115V / 1 / 60 230V / 1 / 60	4.3	11.8* 8.7
RST-115-52	114.75"	2,915mm	115V / 1 / 60 230V / 1 / 60	4.7	12.2* 8.7

\*Call factory: (1) if you have drain accessibility, and/or (2) if you're looking for savings; depending on your geographic location, you could save 900 to 1500 Watts of electrical energy.

SPECS: aluminum support frame; leveling legs; brushed stainless steel interior; epoxy painted upper structure; anodized aluminum trim; .25 tempered shelf; end and front curved glass; tilt-out front glass standard.; lights with spectrum sleeves all shelves; laminated plywood finish; self-contained (R134a) with hot gas evaporator or remote; refrigerated cases are fitted with a defogging system that will keep the front glass clear of moisture in a controlled environment not exceeding 75°F and 55% relative humidity. ETL sanitation listed to NSF Standard 2, 4 and 7.

