

Arctica Signature Series

Presentation is Everything™

Large Self-Service Flat Deck

- MRO-38-42 38.25"L x 41.69"D x 42.00"H
- MRO-48-42 47.81"L x 41.69"D x 42.00"H
- MRO-57-42 57.38"L x 41.69"D x 42.00"H
- MRO-76-42 76.50"L x 41.69"D x 42.00"H
- MRO-96-42 95.63"L x 41.69"D x 42.00"H
- MRO-115-42 114.75"L x 41.69"D x 42.00"H

- Self-Contained
- Remote

*Arctica recommended for:
Beverages and Packaged Foods.*

Item #:	_____
Project:	_____
Date:	_____

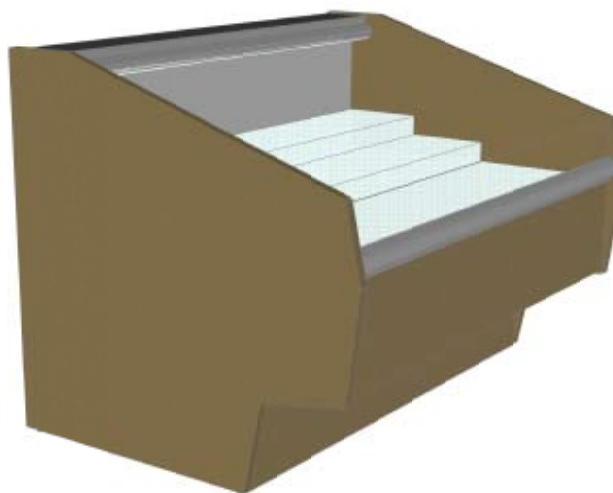

Large Self-Service	Standard Specifications:	Options:
Construction	<input type="checkbox"/> Welded aluminum frame construction <input type="checkbox"/> Levelers <input type="checkbox"/> Brushed steel interior	
Aluminum Trim	<input type="checkbox"/> Satin finish	<input type="checkbox"/> Chrome anodized <input type="checkbox"/> Brass anodized <input type="checkbox"/> Epoxy powder painted (colour): _____
End Panels/Decorboard/ Kickboard	<input type="checkbox"/> Choice of 8 standard colours: _____	<input type="checkbox"/> Hardwood veneer <input type="checkbox"/> Stainless steel
Fold-In-Place Work Shelf	<input type="checkbox"/> Saniboard <input type="checkbox"/> Stainless steel	<input type="checkbox"/> Wilsonart frosty white <input type="checkbox"/> Surell (similar to Corian)
Equipment	<input type="checkbox"/> Removable end panels	<input type="checkbox"/> Stepped inlay <input type="checkbox"/> Energy saving cover

1.800.839.5536

www.arctica.ca



Arctica Signature Series

Presentation is Everything™

Large Self-Service

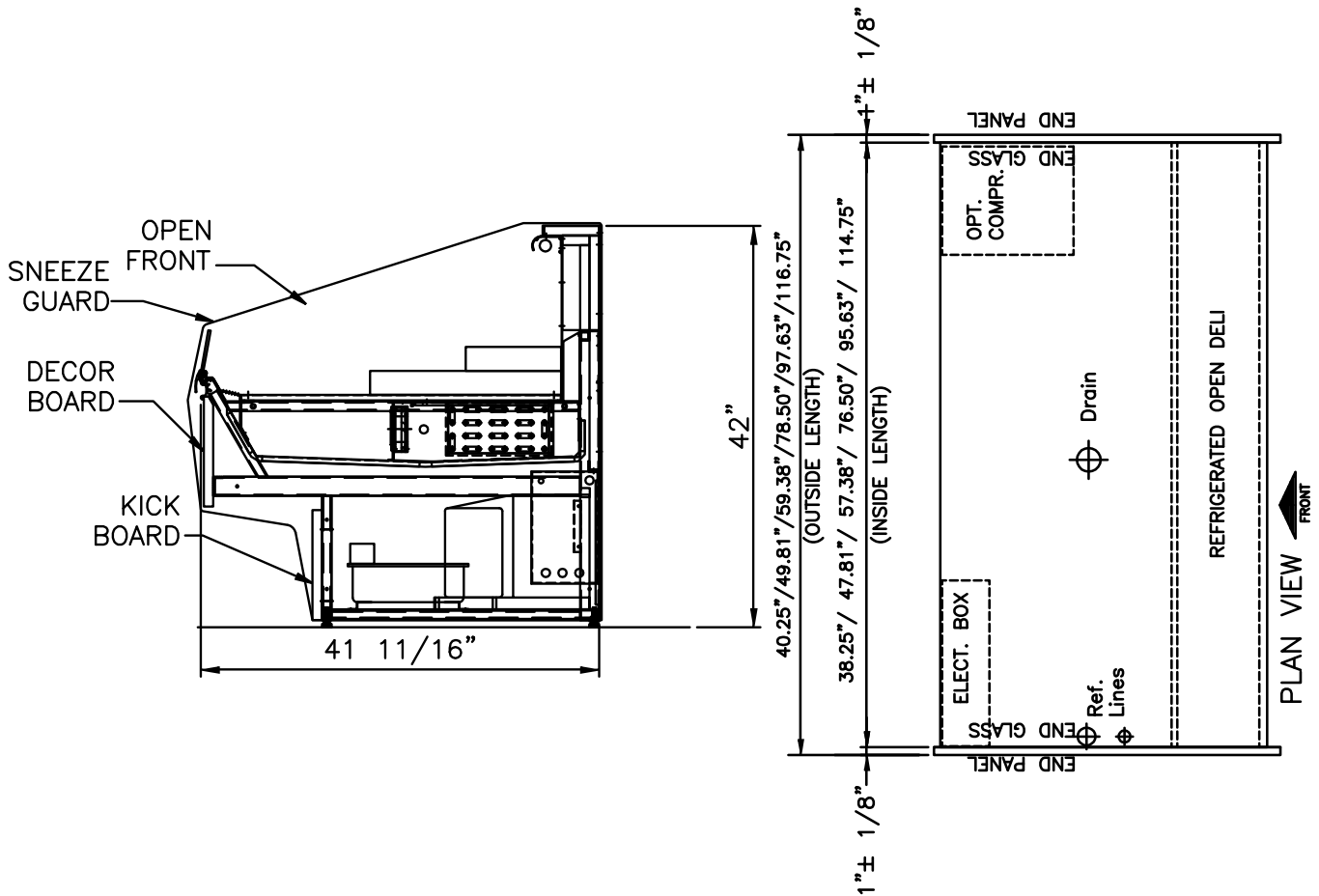

Model	Length (inches)	Length (millimeters)	Voltage	Amps (Remote)	Amps (Self-Contained)
MRO-38-42	38.25"	972mm	115V / 1 / 60	1.2	11.9
MRO-48-42	47.81"	1,214mm	115V / 1 / 60	1.4	12.1
MRO-57-42	57.38"	1,457mm	115V / 1 / 60 230V / 1 / 60	1.6	9.1* 8.7
MRO-76-42	76.50"	1,943mm	115V / 1 / 60 230V / 1 / 60	1.8	9.3* 8.7
MRO-96-42	95.63"	2,429mm	115V / 1 / 60 230V / 1 / 60	2.2	14.7* 9.6
MRO-115-42	114.75"	2,915mm	115V / 1 / 60	2.5	N/A

*Call factory: (1) if you have drain accessibility, and/or (2) if you're looking for savings; depending on your geographic location, you could save 900 to 1500 Watts of electrical energy.

SPECS: aluminum support frame; leveling legs; brushed stainless steel interior; epoxy painted upper structure; anodized aluminum trim; .25 tempered shelf; end and front curved glass; tilt-out front glass standard.; lights with spectrum sleeves all shelves; laminated plywood finish; self-contained (R134a) with hot gas evaporator or remote; ETL sanitation listed to NSF Standard 2, 4 and 7.

