

Arctica Urban Market Series

Presentation is Everything™

Self-Service Dry

- SSD-38-52 38.25"L x 41.13"D x 51.94"H
- SSD-57-52 57.38"L x 41.13"D x 51.94"H
- SSD-76-52 76.50"L x 41.13"D x 51.94"H
- SSD-96-52 95.63"L x 41.13"D x 51.94"H
- SSD-115-52 114.75"L x 41.13"D x 51.94"H

- With baskets
- Without baskets

*Arctica recommended for:
Dry Breads.*

Item #:	_____
Project:	_____
Date:	_____



Self-Service Dry	Standard Specifications:	Options:
Construction	<input type="checkbox"/> High grade plywood <input type="checkbox"/> Aluminum base structure <input type="checkbox"/> Levelers <input type="checkbox"/> Drawer front flat glass	
Interior Finishes	<input type="checkbox"/> Epoxy powder painted (black)	<input type="checkbox"/> Epoxy powder painted (white) <input type="checkbox"/> Epoxy powder painted (colour): <hr/>
Aluminum Trim	<input type="checkbox"/> Satin finish	<input type="checkbox"/> Chrome anodized <input type="checkbox"/> Brass anodized <input type="checkbox"/> Epoxy powder painted (colour): <hr/>
End/Divider Glass	<input type="checkbox"/> 1/4" tempered glass	<input type="checkbox"/> 1/4" tempered glass mirrored
Sliding Doors	<input type="checkbox"/> Pike glass	<input type="checkbox"/> Pike glass with mirror film
End Panels/Decorboard/ Kickboard	<input type="checkbox"/> Plastic laminate on plywood	<input type="checkbox"/> Hardwood veneer <input type="checkbox"/> Stainless Steel

1.800.839.5536

www.arctica.ca



ARCTICA
Urban Market
CUSTOM DISPLAY SYSTEMS

Arctica Urban Market Series

Presentation is Everything™

Self-Service Dry

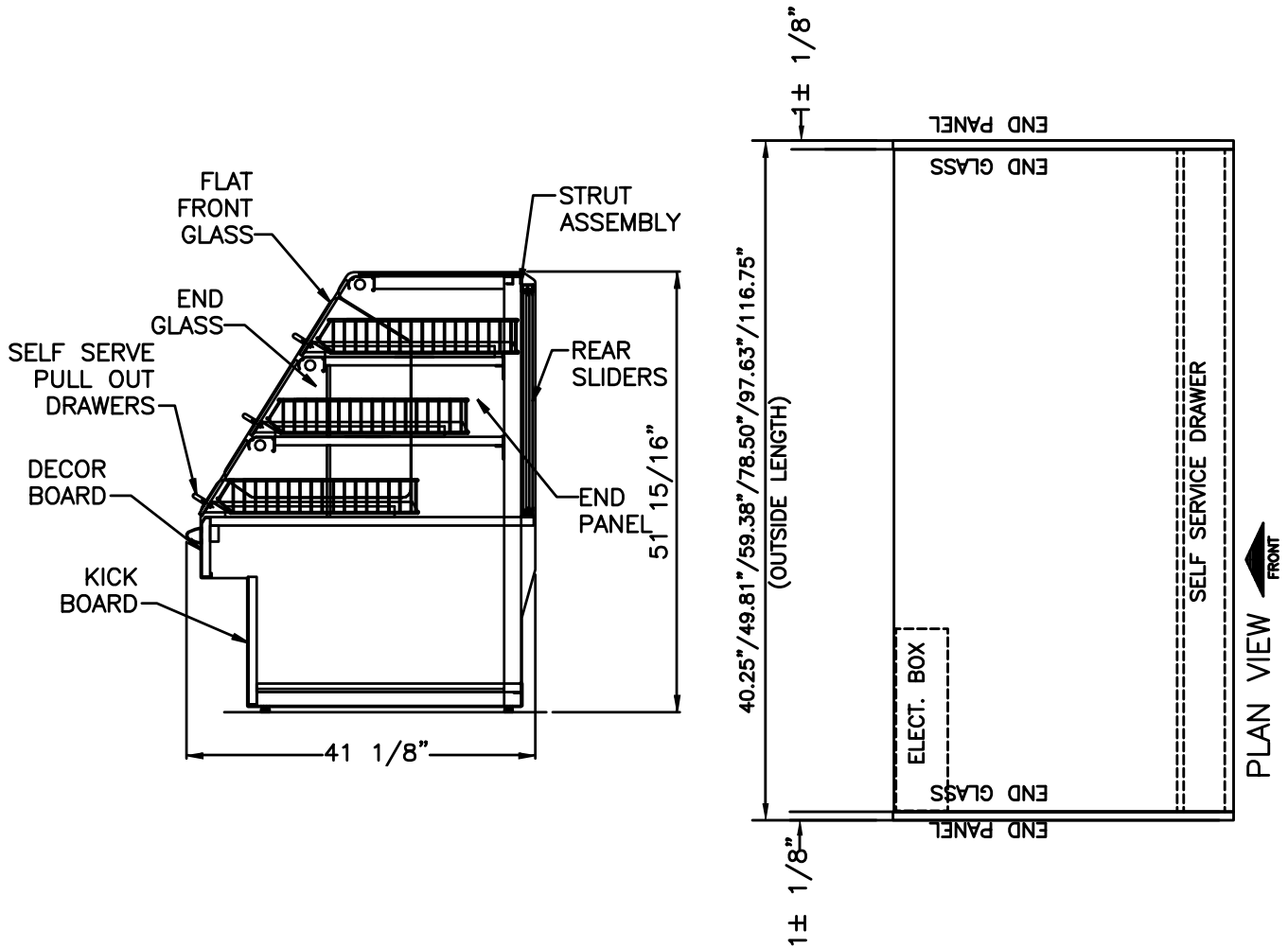

Model	Length (inches)	Length (millimeters)	Voltage	Amps
SSD-38-52	38.25"	972mm	115V / 1 / 60	1.0*
SSD-57-52	57.38"	1,457mm	115V / 1 / 60	1.0*
SSD-76-52	76.50"	1,943mm	115V / 1 / 60	2.0*
SSD-96-52	95.63"	2,429mm	115V / 1 / 60	2.0*
SSD-115-52	114.75"	2,915mm	115V / 1 / 60	2.0*

*Call factory for AMP draw if shelf scale plug is required.

SPECS: aluminum frame; leveling legs; brushed stainless steel interior; epoxy paint upper structure; anodized aluminum trim; .25 tempered end glass; 3/4" plywood finish millwork. ETL sanitation listed to NSF Standard 2, 4 and 7.

